

WBS NO: 2026CPT.03.14.20822

CONTRACT: DC00490

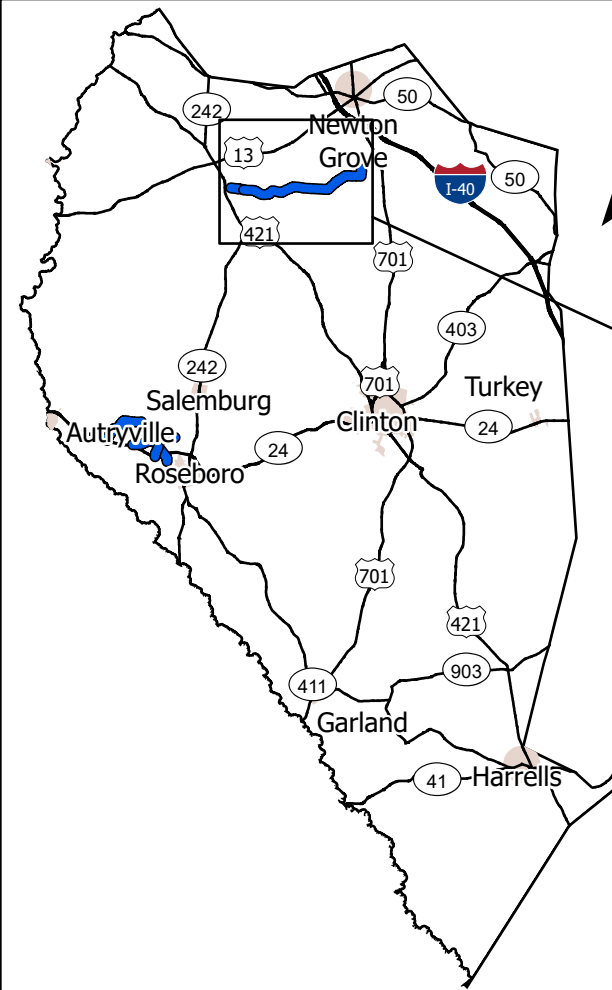

**STATE OF NORTH CAROLINA  
DIVISION OF HIGHWAYS  
DISTRICT 2 SAMPSON & DUPLIN COUNTY**

*TYPE OF WORK: PRESERVATION*

STATE	STATE PROJECT REFERENCE NUMBER	SHEET NO.
NC	2026CPT.03.14.20822	1
STATE PROJECT NUMBER		DESCRIPTION

— Preservation

MAP	ROUTE	DESCRIPTION	TYPE
1	SR-1475 / JB WILSON RD	FROM US 421 (SPIVEY'S CORNER HWY) TO SR 1636 (WASH MCLAMB RD) [MP 3.13 - MP 3.83]	Preservation
2	SR-1636 / ROANOKE RD / WARWICK RD	FROM SR 1843 (WHIT RD) TO SR 1477 (STRAW POND SCHOOL RD) [MP 0.00 - MP 7.14]	Preservation

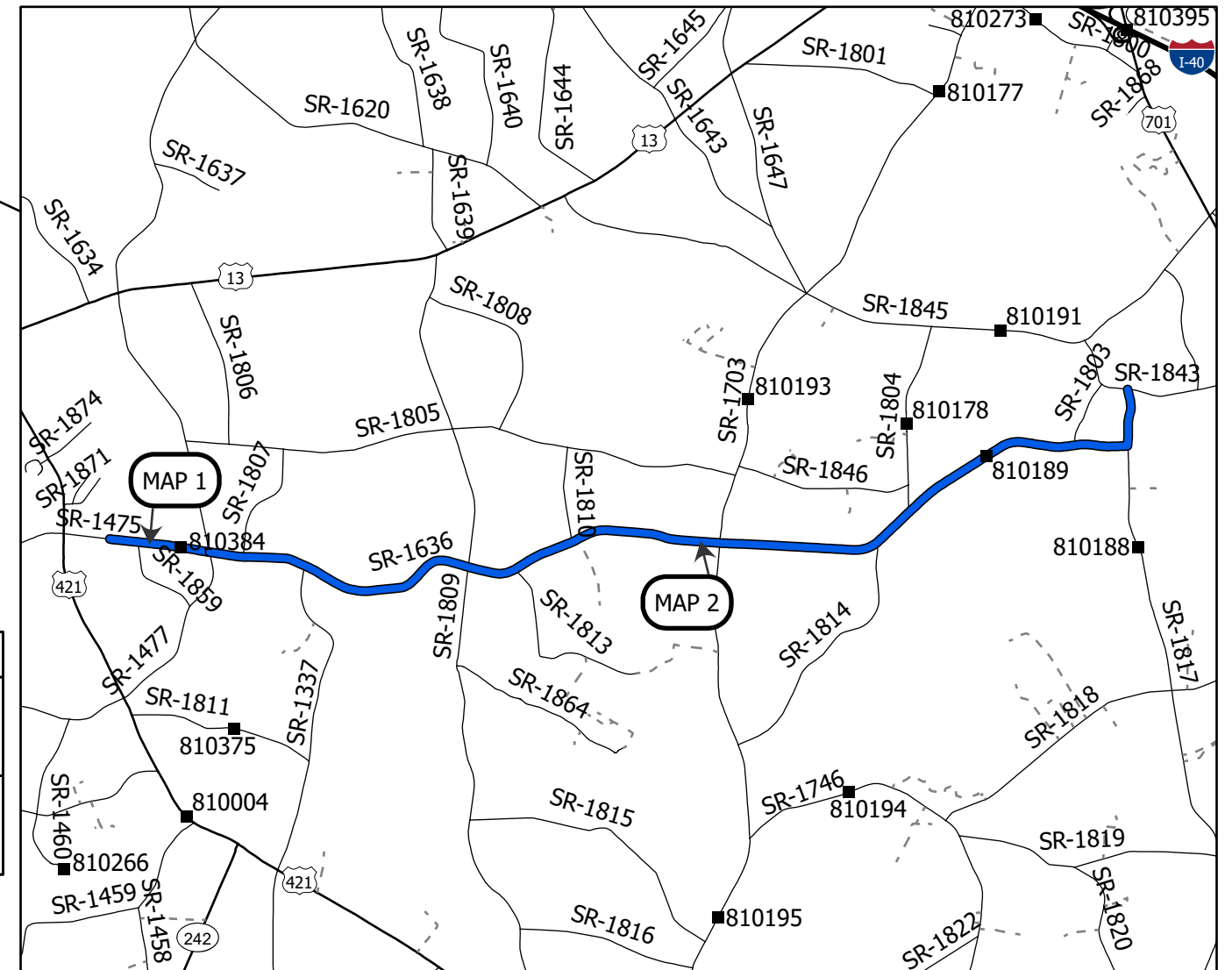

**PROJECT LENGTH**

MAP	MILES
1	0.70
2	7.14

Prepared in the Office of:  
**DIVISION OF HIGHWAYS**  
5501 BARBADOS BLVD., CASTLE HAYNE, NC, 28429

This exhibit does not meet NC 47-30 requirements and therefore is not intended for design, construction, or recording or transfer of title.



WBS NO: 2026CPT.03.14.20822

CONTRACT: DC00490

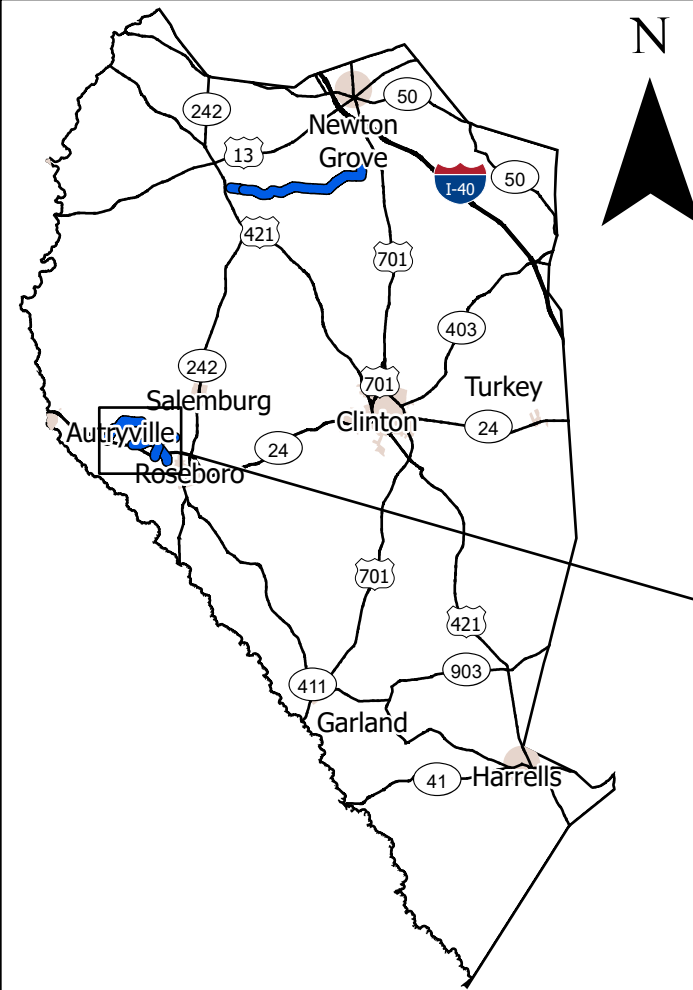

**STATE OF NORTH CAROLINA  
DIVISION OF HIGHWAYS  
DISTRICT 2 SAMPSON & DUPLIN COUNTY**

*TYPE OF WORK: PRESERVATION*

STATE	STATE PROJECT REFERENCE NUMBER	SHEET NO.
NC	2026CPT.03.14.20822	2
STATE PROJECT NUMBER		DESCRIPTION

— Preservation

MAP	ROUTE	DESCRIPTION	TYPE
3	SR-1405 / PLEASANT UNION RD	FROM NC 24 (AUTRY HWY) TO SR 1002 (DUNN RD) [MP 0.07 - MP 2.38]	Preservation
4	SR-1256 / CARRY BRIDGE RD	FROM NC 24 (AUTRY HWY) TO SR 1406 (BOREN BRICK RD) [MP 3.44 - MP 5.86]	Preservation
5	SR-1403 / OLD BRICK MILL RD	FROM SR 1405 (PEASANT UNION RD) TO SR 1515 (W DR MARTIN L KING JR BLVD) [MP 0.00 - MP 1.37]	Preservation
6	SR-1404 / DOWDY RD	FROM SR 1403 (OLD BRICK MILL RD) TO NC 24 (AUTRY HWY) [MP 0.00 - MP 0.56]	Preservation

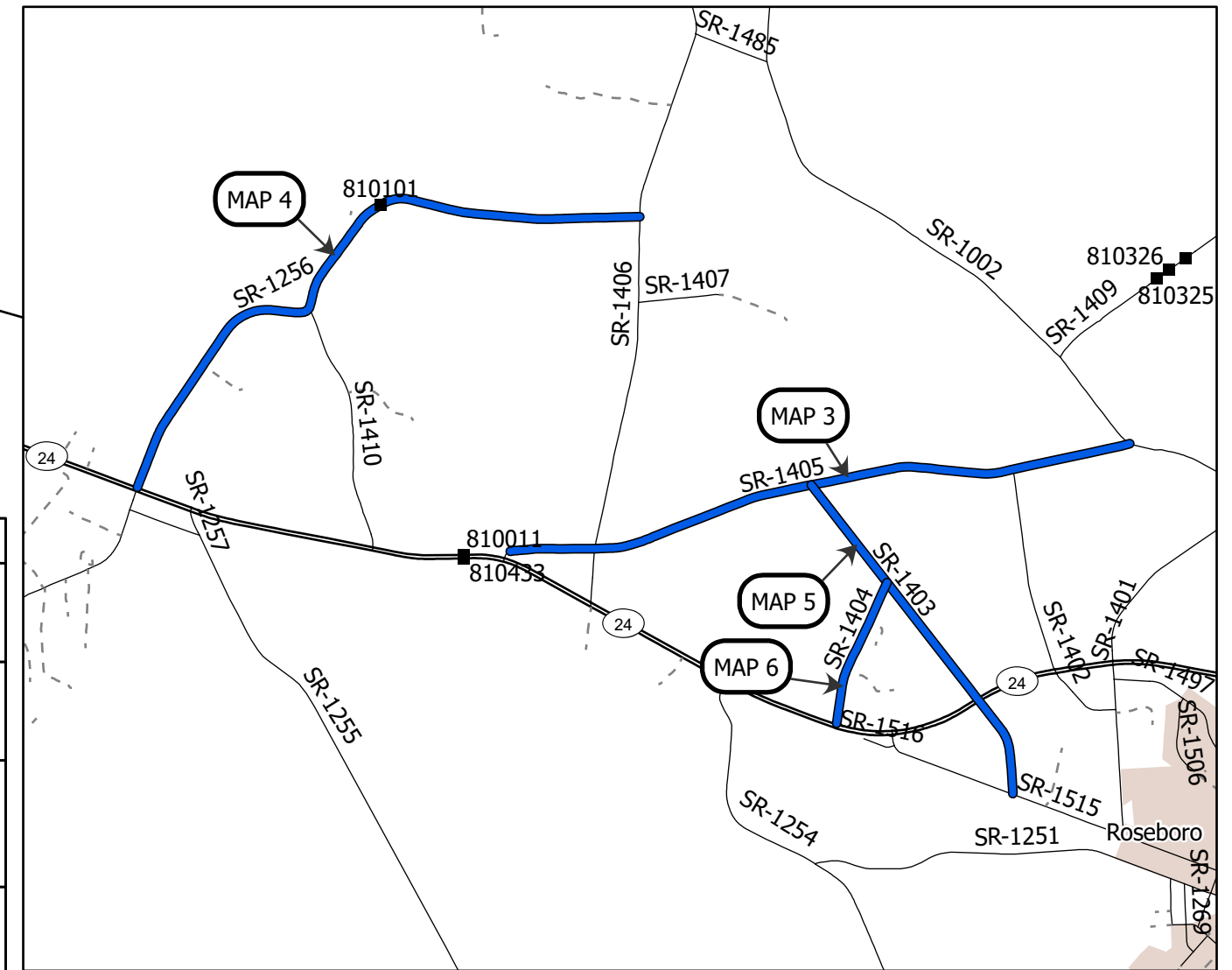

<i>PROJECT LENGTH</i>	
MAP	MILES
3	2.31
4	2.42
5	1.37
6	0.56

Prepared in the Office of:  
**DIVISION OF HIGHWAYS**  
5501 BARBADOS BLVD., CASTLE HAYNE, NC, 28429

**This exhibit does not meet NC 47-30 requirements and therefore is not intended for design, construction, or recording or transfer of title.**



WBS NO: 2026CPT.03.14.20312

CONTRACT: DC00490

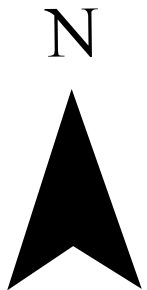
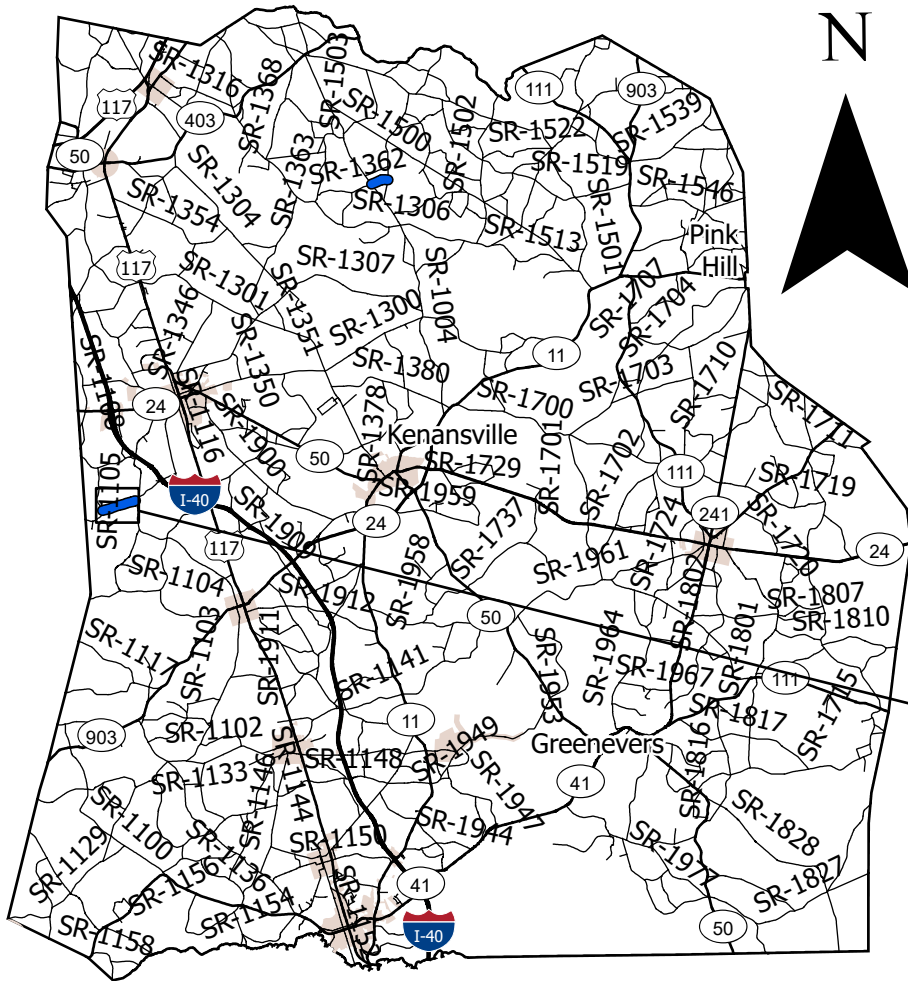

STATE OF NORTH CAROLINA  
 DIVISION OF HIGHWAYS  
 DISTRICT 2 SAMPSON & DUPLIN COUNTY

TYPE OF WORK: PRESERVATION

STATE	STATE PROJECT REFERENCE NUMBER	SHEET NO.
NC	2026CPT.03.14.20312	3
STATE PROJECT NUMBER		DESCRIPTION

— Preservation

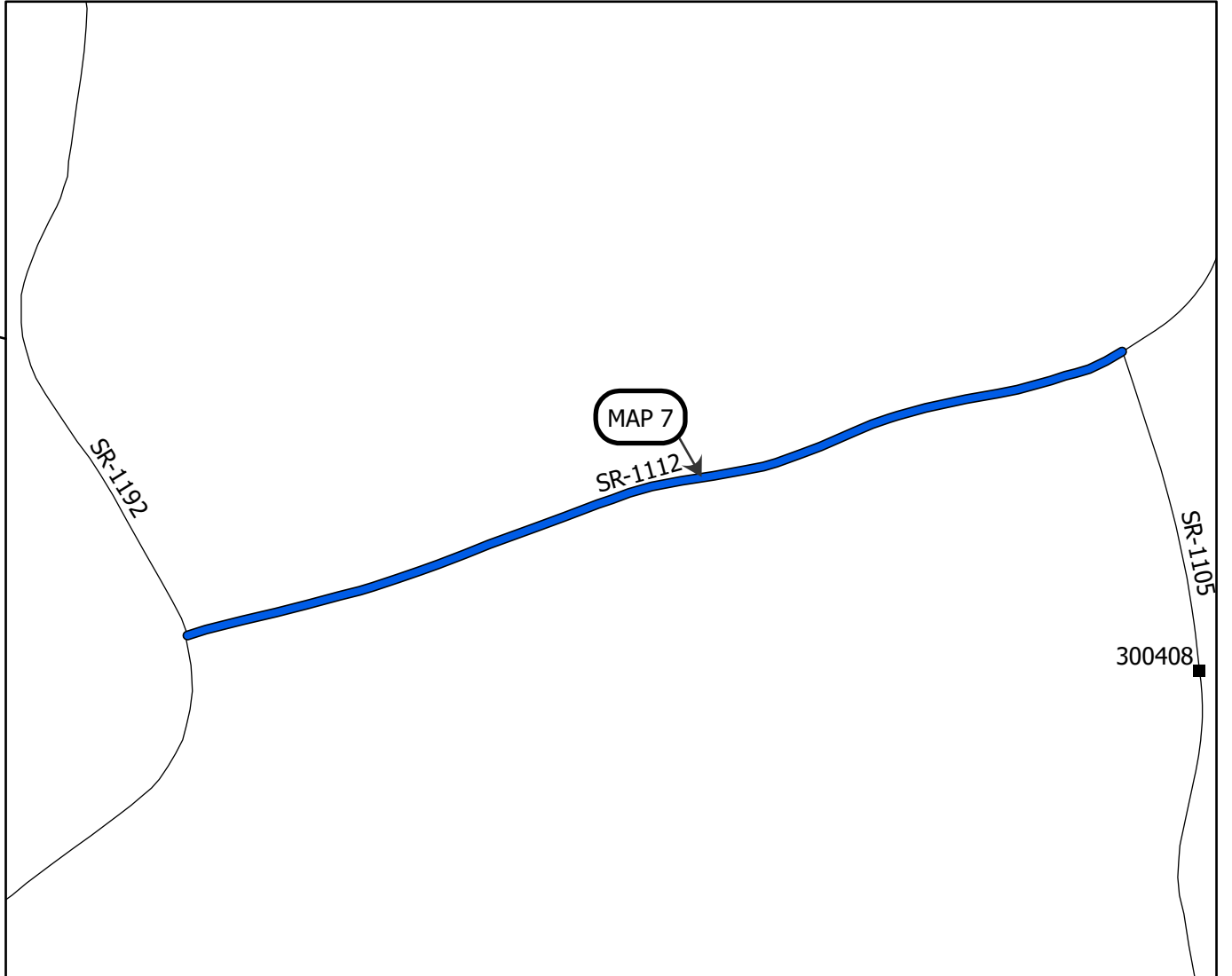

MAP	ROUTE	DESCRIPTION	TYPE
7	SR-1112 / BUCK HALL CREEK RD	FROM SR 1105 (CARLTON CHAPEL CHURCH RD) TO SR 1192 (CARROLLS RD) [MP 0.00 - MP 1.18	Preservation

PROJECT LENGTH

MAP	MILES
7	1.18

Prepared in the Office of:  
**DIVISION OF HIGHWAYS**  
 5501 BARBADOS BLVD., CASTLE HAYNE, NC, 28429

This exhibit does not meet NC 47-30 requirements and therefore is not intended for design, construction, or recording or transfer of title.

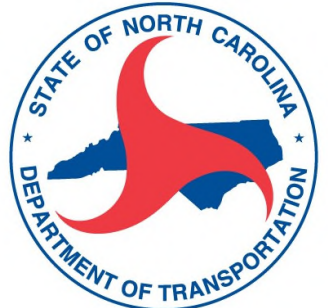

WBS NO: 2026CPT.03.14.20312

CONTRACT: DC00490

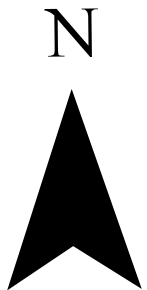
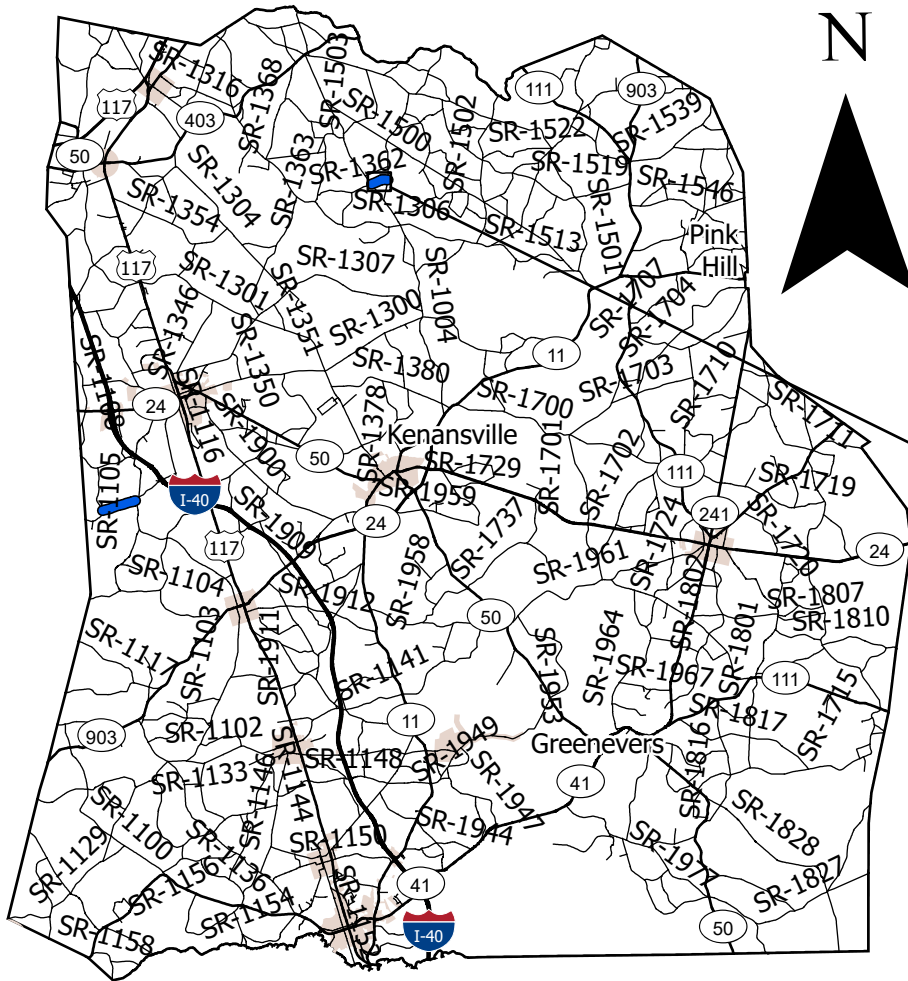

**STATE OF NORTH CAROLINA  
DIVISION OF HIGHWAYS  
DISTRICT 2 SAMPSON & DUPLIN COUNTY**

*TYPE OF WORK: PRESERVATION*

STATE	STATE PROJECT REFERENCE NUMBER	SHEET NO.
NC	2026CPT.03.14.20312	4
STATE PROJECT NUMBER		DESCRIPTION

— Preservation

MAP	ROUTE	DESCRIPTION	TYPE
8	SR-1561 / JIM OUTLAW RD	FROM SR 1004 (SUMMERLINS CROSSROAD RD) TO SR 1505 (BETHEL CHURCH RD) [MP 0.00 - MP 0.60]	Preservation

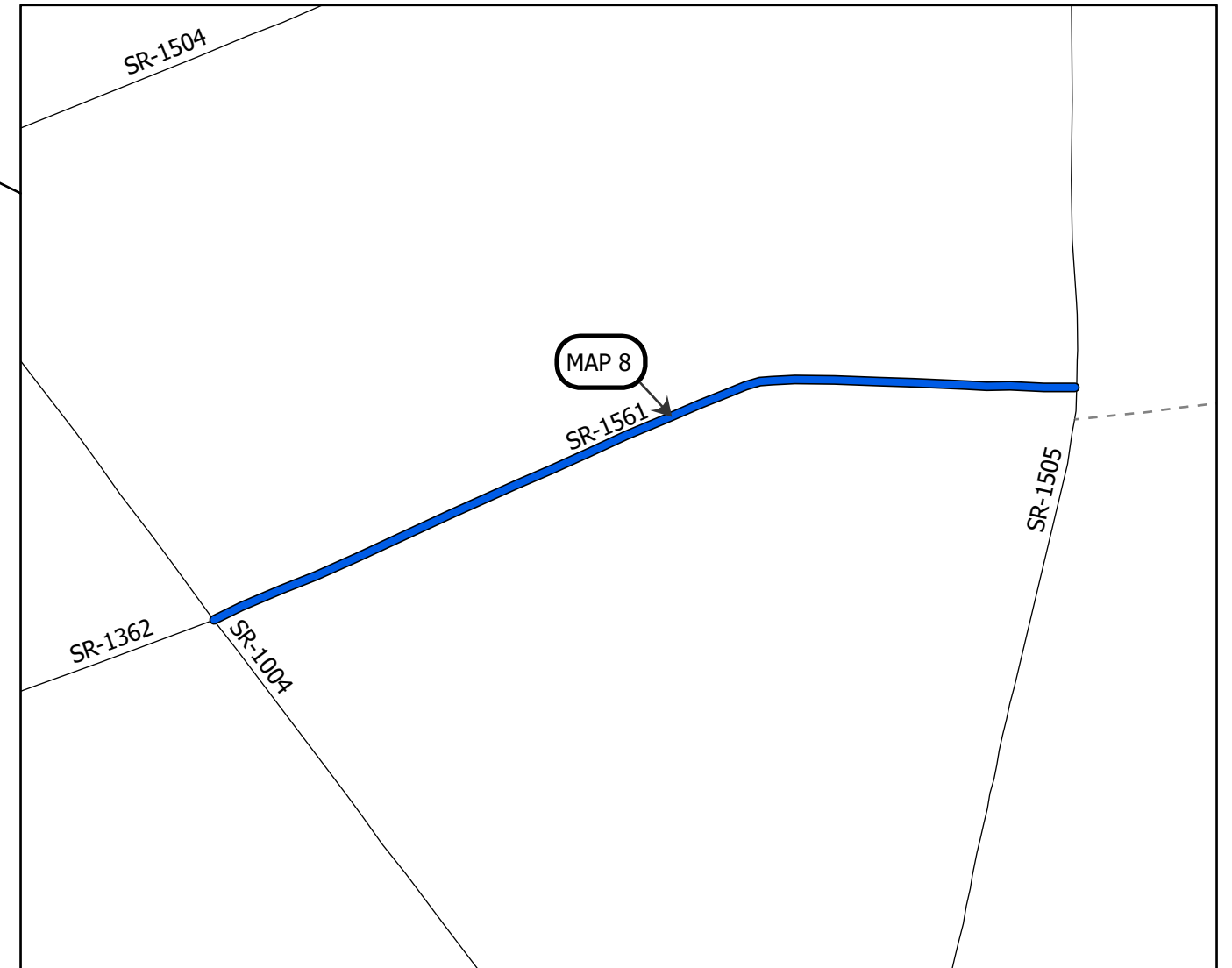

**PROJECT LENGTH**

MAP	MILES
8	0.60

Prepared in the Office of:  
**DIVISION OF HIGHWAYS**  
5501 BARBADOS BLVD., CASTLE HAYNE, NC, 28429

This exhibit does not meet NC 47-30 requirements and therefore is not intended for design, construction, or recording or transfer of title.



PAVEMENT SCHEDULE	
C1	PROP. ASPHALT SURFACE TREATMENT DOUBLE SEAL
C2	PROP. ASPHALT SURFACE TREATMENT, FOG SEAL, AT AN AVERAGE RATE OF 0.09-0.15 GAL. PER SQ.YD
U	EXISTING PAVEMENT

PAVEMENT EDGE SLOPES ARE 1:1, EXCEPT FINAL SURFACE COURSE. SEE SHOULDER WEDGE DETAIL.

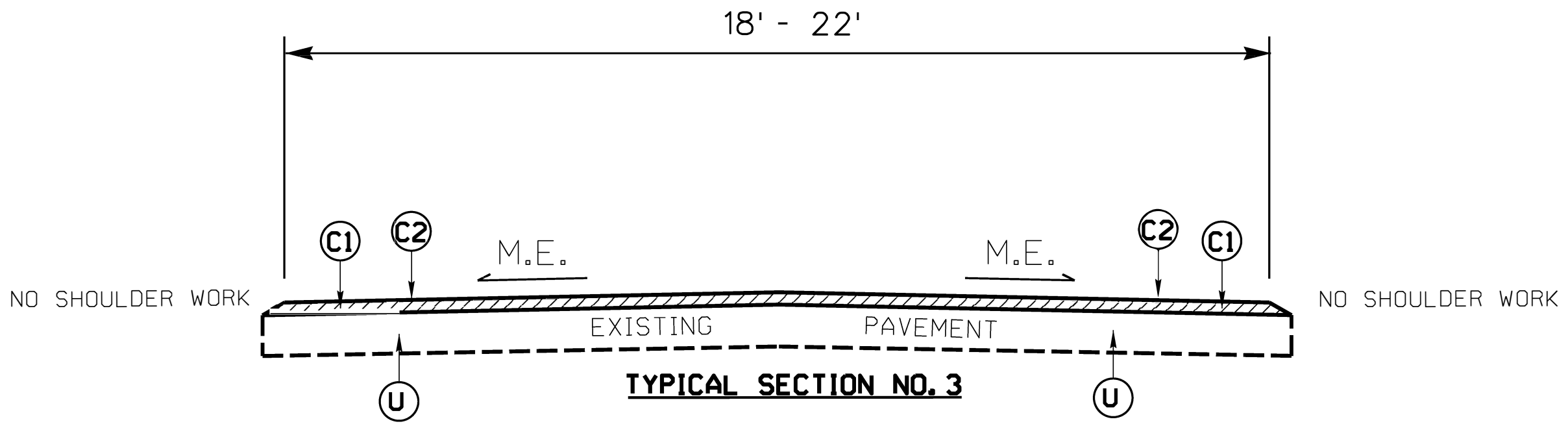

MAP NO. 1  
 SR 1475 (JB WILSON RD)  
 MP 3.13 - MP 3.83

MAP NO. 2  
 SR 1636 (ROANOKE RD/WARWICK RD)  
 MP 0.00 - MP 7.14

MAP NO. 3  
 SR 1405 (PLEASANT UNION RD)  
 MP 0.07 - MP 2.38

MAP NO. 4  
 SR 1256 (CARRY BRIDGE RD)  
 MP 3.44 - MP 5.86

MAP NO. 5  
 SR 1403 (OLD BRICK MILL RD)  
 MP 0.00 - MP 1.37

MAP NO. 6  
 SR 1404 (DOWDY RD)  
 MP 0.00 - MP 0.56

MAP NO. 7  
 SR 1112 (BUCK HALL CREEK RD)  
 MP 0.00 - MP 1.18

MAP NO. 8  
 SR 1561 (JIM OUTLAW RD)  
 MP 0.00 - MP 0.60

REVISIONS

8/17/99  
 SYSTEMS  
 11/11/03



# SIGNING FOR ASPHALT SURFACE TREATMENT

**LEGEND**

- ◻ PORTABLE SIGN
- └ STATIONARY SIGN
- ← DIRECTION OF TRAFFIC FLOW

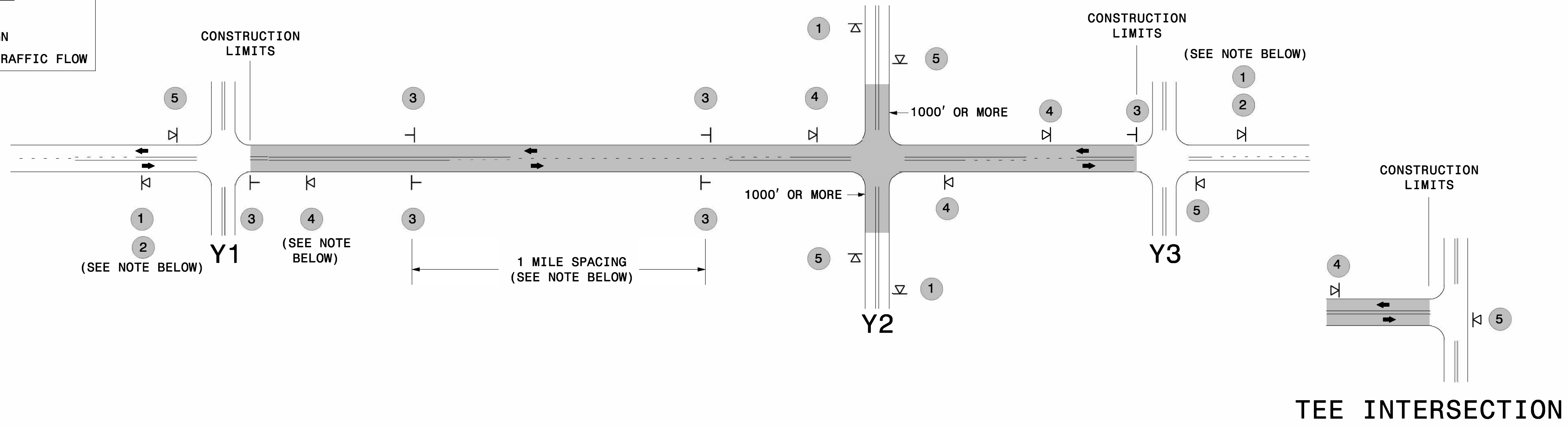

## MAINLINE (-L-) SIGNING

## -Y- LINE SIGNING

SIGNING NOTES AND PLACEMENT PER DIRECTION	<p>1</p> <p>2</p>	<p>- PLACE 1000' PRIOR TO BEGINNING OF CONSTRUCTION LIMITS. ONLY USED ON -Y- LINES IF RESURFACING LIMITS EXTEND 1000' ALONG -Y- LINE.</p> <p>- SIGN #2 ONLY USED WHEN RESURFACING LIMITS ARE 2 OR MORE MILES IN LENGTH. ROUND UP TO THE NEAREST WHOLE NUMBER. DO NOT USE FRACTIONAL OR DECIMAL NUMBERS.</p>	<p>STATIONARY SIGNING NOT REQUIRED FOR THE FOLLOWING -Y- LINE CONDITIONS:</p> <ol style="list-style-type: none"> <li>1) LESS THAN 1000' OF RESURFACING ALONG -Y- LINE</li> <li>2) SUBDIVISION ROADS</li> <li>3) DEAD END ROADS</li> </ol> <p>WHEN PAVING/CONSTRUCTION ACTIVITIES PROCEED ACROSS AN UNSIGNED -Y- LINE, PORTABLE ADVANCE WARNING SIGNS SHALL BE USED ALONG THE -Y- LINE AS SHOWN BELOW. REMOVE UPON COMPLETION OF WORK.</p> <div style="display: flex; justify-content: space-around;"> <div> <p>PLACED 500' IN ADVANCE OF FLAGGER.</p> </div> <div> <p>PLACED 250' IN ADVANCE OF FLAGGER.</p> </div> </div>
	<p>3</p>	<p>- ALTERNATE THE FOLLOWING TWO SIGNS:</p> <p>- STARTING WITH "LOOSE GRAVEL" (W8-7) FOLLOWED BY "UNMARKED PAVEMENT".</p> <p>- PLACE INITIALLY AT THE CONSTRUCTION LIMITS AND SPACED 1 MILE APART THEREAFTER.</p> <p>- AT TEE INTERSECTIONS INSTALL INITIALLY 0.5 MILE FROM INTERSECTION AND SPACE 1 MILE APART THEREAFTER.</p>	
	<p>4</p>	<p>- THESE ARE FOR -Y- LINES THAT ARE "THROUGH" ROADWAYS. DEAD END AND SUBDIVISION ROADS ARE NOT "THROUGH" ROADWAYS.</p> <p>- INSTALL 500' +/- FROM EACH -Y- LINE APPROACH AS SHOWN ABOVE.</p> <p>- FOR MULTIPLE -Y- LINES THAT ARE SEPARATED BY 0.25 MILES OR LESS, TREAT AS A SINGLE UNIT AND INSTALL WITHIN 500' OF EACH APPROACH.</p> <p>- A MAXIMUM OF 2 SIGN SETS PER MILE. DO NOT INSTALL WHEN -Y- LINES ARE WITHIN 0.5 MILES FROM "END ROAD WORK" SIGN.</p>	
	<p>5</p>	<p>PLACE 500' FOLLOWING THE END OF CONSTRUCTION LIMITS OR AS SHOWN WHEN WORK ENDS AT A 3-WAY TEE INTERSECTION.</p>	
	<p>THE ABOVE SIGNS ARE ALL THAT ARE REQUIRED FOR A CONTRACTOR TO BEGIN A RESURFACING CONTRACT. ANY ADDITIONAL SIGNS REQUESTED BY NCDOT DIVISIONS SHALL BE INSTALLED WITHIN 7 BUSINESS DAYS OF THE START OF CONTRACT WORK.</p>		

**MAPS LESS THAN 2 MILES**

FOR AST RESURFACING MAPS WITH CONSTRUCTION LIMITS LESS THAN 2 MILES IN LENGTH, USE A STATIONARY "LOOSE GRAVEL" SIGN AT THE BEGINNING CONSTRUCTION LIMIT FOLLOWED BY AN "UNMARKED PAVEMENT" SIGN MIDWAY THROUGH AND AN "END ROAD WORK" SIGN AT THE END CONSTRUCTION LIMIT.



**ADVANCE WARNING SIGNS FOR 2-LANE ROADWAY ASPHALT SURFACE TREATMENT**

PROJECT NO.	SHEET NO.
2026CPT.03.14.20822	7
2026CPT.03.14.20312	

# SUMMARY OF QUANTITIES

PROJECT NO	COUNTY	MAP NO	ROUTE	DESCRIPTION	TYP NO	LANES	LANE TYPE	LENGTH	WIDTH	BEGI N MP	END MP	1803500000-E	1820000000-E	1838000000-E
								MI	FT			SY	SY	GAL
2026CPT.03.14.20822	Sampson	1	SR-1475 / JB WILSON RD	FROM US 421 (SPIVEY'S CORNER HWY) TO SR 1636 (WASH MCLAMB RD) [MP 3.13 - MP 3.83]	1	2	2WU	0.70	20	3.13	3.83	12,082	12,082	6,650
<b>TOTAL FOR MAP NO. 1</b>								<b>0.70</b>				<b>12,082</b>	<b>12,082</b>	<b>6,650</b>
2026CPT.03.14.20822	Sampson	2	SR-1636 / ROANOKE RD / WARWICK RD	FROM SR 1843 (WHIT RD) TO SR 1477 (STRAW POND SCHOOL RD) [MP 0.00 - MP 7.14]	1	2	2WU	7.14	18	0.00	7.14	83,729	83,729	46,055
<b>TOTAL FOR MAP NO. 2</b>								<b>7.14</b>				<b>83,729</b>	<b>83,729</b>	<b>46,055</b>
2026CPT.03.14.20822	Sampson	3	SR-1405 / PLEASANT UNION RD	FROM NC 24 (AUTRY HWY) TO SR 1002 (DUNN RD) [MP 0.07 - MP 2.38]	1	2	2WU	2.31	20	0.07	2.38	27,104	27,104	14,910
<b>TOTAL FOR MAP NO. 3</b>								<b>2.31</b>				<b>27,104</b>	<b>27,104</b>	<b>14,910</b>
2026CPT.03.14.20822	Sampson	4	SR-1256 / CARRY BRIDGE RD	FROM NC 24 (AUTRY HWY) TO SR 1406 (BOREN BRICK RD) [MP 3.44 - MP 5.86]	1	2	2WU	2.42	20	3.44	5.86	28,395	28,395	15,620
<b>TOTAL FOR MAP NO. 4</b>								<b>2.42</b>				<b>28,395</b>	<b>28,395</b>	<b>15,620</b>
2026CPT.03.14.20822	Sampson	5	SR-1403 / OLD BRICK MILL RD	FROM SR 1405 (PEASANT UNION RD) TO SR 1515 (W DR MARTIN L KING JR BLVD) [MP 0.00 - MP 1.37]	1	2	2WU	1.37	20	0.00	1.37	16,075	16,075	8,845
<b>TOTAL FOR MAP NO. 5</b>								<b>1.37</b>				<b>16,075</b>	<b>16,075</b>	<b>8,845</b>
2026CPT.03.14.20822	Sampson	6	SR-1404 / DOWDY RD	FROM SR 1403 (OLD BRICK MILL RD) TO NC 24 (AUTRY HWY) [MP 0.00 - MP 0.56]	1	2	2WU	0.56	20	0.00	0.56	6,571	6,571	3,615
<b>TOTAL FOR MAP NO. 6</b>								<b>0.56</b>				<b>6,571</b>	<b>6,571</b>	<b>3,615</b>
<b>TOTAL FOR PROJ NO. 2026CPT.03.14.20822</b>								<b>14.50</b>				<b>173,956</b>	<b>173,956</b>	<b>95,695</b>
2026CPT.03.14.20312	Duplin	7	SR-1112 / BUCK HALL CREEK RD	FROM SR 1105 (CARLTON CHAPEL CHURCH RD) TO SR 1192 (CARROLLS RD) [MP 0.00 - MP 1.18]	1	2	2WU	1.18	20	0.00	1.18	13,846	13,846	7,620
<b>TOTAL FOR MAP NO. 7</b>								<b>1.18</b>				<b>13,846</b>	<b>13,846</b>	<b>7,620</b>
2026CPT.03.14.20312	Duplin	8	SR-1561 / JIM OUTLAW RD	FROM SR 1004 (SUMMERLINS CROSSROAD RD) TO SR 1505 (BETHEL CHURCH RD) [MP 0.00 - MP 0.60]	1	2	2WU	0.60	20	0.00	0.60	7,024	7,024	3,865
<b>TOTAL FOR MAP NO. 8</b>								<b>0.60</b>				<b>7,024</b>	<b>7,024</b>	<b>3,865</b>
<b>TOTAL FOR PROJ NO. 2026CPT.03.14.20312</b>								<b>1.78</b>				<b>20,870</b>	<b>20,870</b>	<b>11,485</b>
<b>GRAND TOTAL</b>								<b>16.28</b>				<b>194,826</b>	<b>194,826</b>	<b>107,180</b>

PROJECT NO.	SHEET NO.
2026CPT.03.14.20822	8
2026CPT.03.14.20312	

# THERMOPLASTIC AND PAINT QUANTITIES

PROJECT NO	COUNTY	MAP NO	ROUTE	DESCRIPTION	TYP NO	LANES	LANE TYPE	LENGTH	WIDTH	BEGIN MP	END MP	4413000000-E	4457000000-N	4685000000-E		4688000000-E		4709000000-E	4720000000-E	4900000000-N	
								MI	FT			WORK ZONE ADVANCE/ GENERAL WARNING SIGNING	TEMPORARY TRAFFIC CONTROL	4" X 90 M WHITE THERMO	4" X 90 M YELLOW THERMO	6" X 90 M WHITE THERMO	6" X 90 M YELLOW THERMO	THERMOPLASTIC PAVEMENT MARKING LINES (24" X 90 MILS)	THERMO MSG SCHOOL (90 MIL)	YELLOW & YELLOW MARKERS	
								SF	LS	LF	LF	LF	LF	LF	EA	EA					
2026CPT.03.14.20822	Sampson	1	SR-1475 / JB WILSON RD	FROM US 421 (SPIVEY'S CORNER HWY) TO SR 1636 (WASH MCLAMB RD) [MP 3.13 - MP 3.83]	1	2	2WU	0.70	20	3.13	3.83	78	0.04	22,212	16,642			20	6	105	
<b>TOTAL FOR MAP NO. 1</b>								<b>0.70</b>				<b>78</b>	<b>0.04</b>	<b>22,212</b>	<b>16,642</b>			<b>20</b>	<b>6</b>	<b>105</b>	
2026CPT.03.14.20822	Sampson	2	SR-1636 / ROANOKE RD / WARWICK RD	FROM SR 1843 (WHIT RD) TO SR 1477 (STRAW POND SCHOOL RD) [MP 0.00 - MP 7.14]	1	2	2WU	7.14	18	0.00	7.14	800	0.44			153,567	94,195			471	
<b>TOTAL FOR MAP NO. 2</b>								<b>7.14</b>				<b>800</b>	<b>0.44</b>			<b>153,567</b>	<b>94,195</b>			<b>471</b>	
2026CPT.03.14.20822	Sampson	3	SR-1405 / PLEASANT UNION RD	FROM NC 24 (AUTRY HWY) TO SR 1002 (DUNN RD) [MP 0.07 - MP 2.38]	1	2	2WU	2.31	20	0.07	2.38	258	0.14	49,711	30,492					157	
<b>TOTAL FOR MAP NO. 3</b>								<b>2.31</b>				<b>258</b>	<b>0.14</b>	<b>49,711</b>	<b>30,492</b>						<b>157</b>
2026CPT.03.14.20822	Sampson	4	SR-1256 / CARRY BRIDGE RD	FROM NC 24 (AUTRY HWY) TO SR 1406 (BOREN BRICK RD) [MP 3.44 - MP 5.86]	1	2	2WU	2.42	20	3.44	5.86	520	0.15			52,078	31,944			164	
<b>TOTAL FOR MAP NO. 4</b>								<b>2.42</b>				<b>520</b>	<b>0.15</b>			<b>52,078</b>	<b>31,944</b>			<b>164</b>	
2026CPT.03.14.20822	Sampson	5	SR-1403 / OLD BRICK MILL RD	FROM SR 1405 (PEASANT UNION RD) TO SR 1515 (W DR MARTIN L KING JR BLVD) [MP 0.00 - MP 1.37]	1	2	2WU	1.37	20	0.00	1.37	294	0.08	36,990	22,687					138	
<b>TOTAL FOR MAP NO. 5</b>								<b>1.37</b>				<b>294</b>	<b>0.08</b>	<b>36,990</b>	<b>22,687</b>						<b>138</b>
2026CPT.03.14.20822	Sampson	6	SR-1404 / DOWDY RD	FROM SR 1403 (OLD BRICK MILL RD) TO NC 24 (AUTRY HWY) [MP 0.00 - MP 0.56]	1	2	2WU	0.56	20	0.00	0.56	120	0.04	12,052	9,030					58	
<b>TOTAL FOR MAP NO. 6</b>								<b>0.56</b>				<b>120</b>	<b>0.04</b>	<b>12,052</b>	<b>9,030</b>						<b>58</b>
<b>TOTAL FOR PROJ NO. 2026CPT.03.14.20822</b>								<b>14.50</b>				<b>2,070</b>	<b>0.89</b>	<b>120,965</b>	<b>78,851</b>	<b>205,645</b>	<b>126,139</b>	<b>20</b>	<b>6</b>	<b>1,093</b>	
												<b>199,816</b>		<b>331,784</b>							
2026CPT.03.14.20312	Duplin	7	SR-1112 / BUCK HALL CREEK RD	FROM SR 1105 (CARLTON CHAPEL CHURCH RD) TO SR 1192 (CARROLLS RD) [MP 0.00 - MP 1.18]	1	2	2WU	1.18	20	0.00	1.18	253	0.07	31,860	19,541					119	
<b>TOTAL FOR MAP NO. 7</b>								<b>1.18</b>				<b>253</b>	<b>0.07</b>	<b>31,860</b>	<b>19,541</b>					<b>119</b>	
2026CPT.03.14.20312	Duplin	8	SR-1561 / JIM OUTLAW RD	FROM SR 1004 (SUMMERLINS CROSSROAD RD) TO SR 1505 (BETHEL CHURCH RD) [MP 0.00 - MP 0.60]	1	2	2WU	0.60	20	0.00	0.60	129	0.04	12,912	9,674					62	
<b>TOTAL FOR MAP NO. 8</b>								<b>0.60</b>				<b>129</b>	<b>0.04</b>	<b>12,912</b>	<b>9,674</b>					<b>62</b>	
<b>TOTAL FOR PROJ NO. 2026CPT.03.14.20312</b>								<b>1.78</b>				<b>382</b>	<b>0.11</b>	<b>44,772</b>	<b>29,215</b>					<b>181</b>	
												<b>73,987</b>									
<b>GRAND TOTAL</b>								<b>16.28</b>				<b>2,452</b>	<b>1</b>	<b>165,737</b>	<b>108,066</b>	<b>205,645</b>	<b>126,139</b>	<b>20</b>	<b>6</b>	<b>1,274</b>	
												<b>273,803</b>		<b>331,784</b>							